

BM#43 CHISELED SQUARE
S.E. COR. S. HDWL
STA. 396+43, 27' RT.
EL. 1134.97

BM#44 2" ALUM. CAP
END OF OVERPASS I-44
EL. 1144.60

FED. ROAD DIST. NO.	STATE	JOB PIECE NO.	FISCAL YEAR	SHEET NO.	TOTAL SHEETS
6	OKLA.	27050(04)	2017		

REVISIONS

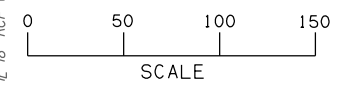

SCALE



- SEE SHEET 42 FOR RAMP B PROFILE
- SEE SHEET 47 FOR RAMP B-C PROFILE
- SEE SHEET 43 FOR RAMP C PROFILE
- SEE SHEETS 26 - 33 FOR GEOMETRIC DATA
- SEE SHEETS 65 - 69 FOR PAVEMENT DETAILS

LEGEND

- PROPOSED PAVEMENT
- PROPOSED RAISED MEDIAN
- DRAINAGE STRUCTURE
- BORING LOCATION

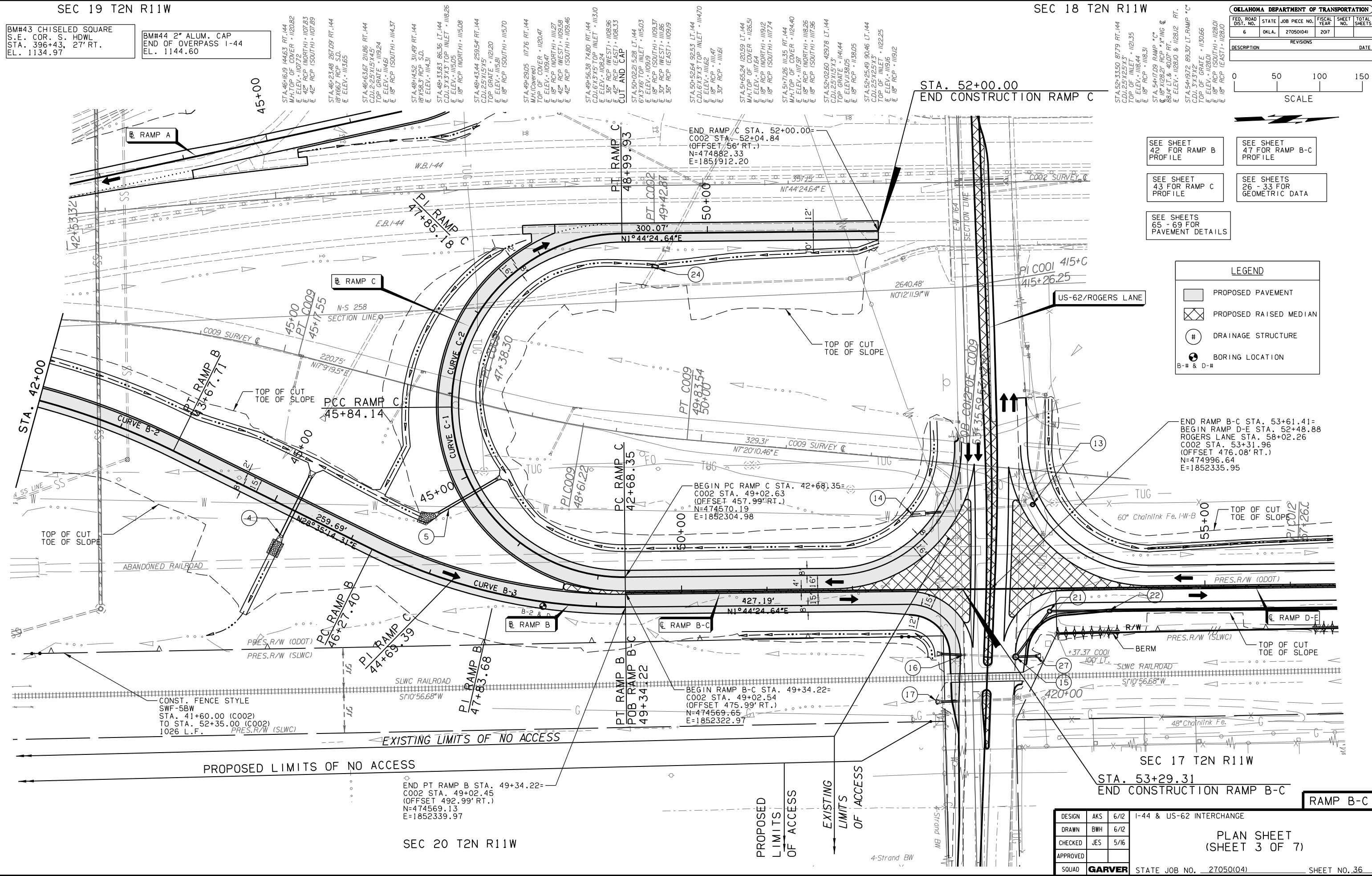

PROPOSED LIMITS OF NO ACCESS

EXISTING LIMITS OF NO ACCESS

PROPOSED LIMITS OF ACCESS
EXISTING LIMITS OF ACCESS

STA. 53+29.31
END CONSTRUCTION RAMP B-C

RAMP B-C

DESIGN	AKS	6/12	I-44 & US-62 INTERCHANGE	
DRAWN	BWH	6/12		
CHECKED	JES	5/16		
APPROVED				
SQUAD	GARVER	STATE JOB NO.	27050(04)	SHEET NO. 36

PLAN SHEET
(SHEET 3 OF 7)